



Rotorua GP CME 2015

General Practice Conference & Medical Exhibition



www.gpcme.co.nz



11-14 June 2015 | Energy Events Centre | Rotorua

You are invited to attend Rotorua GPCME 2015 to be held at the Energy Events Centre in Rotorua in June 2015. This has grown to be New Zealand's premier medical conference providing broad medical update and practical take home information to improve your patient management immediately. A large number of GPs attend each year, over 800 in 2014. This is complemented by a very large exhibition from industry to inform what is new on the pharmaceutical and supply of equipment, texts and available IT solutions, all while gaining sufficient CPD points to satisfy our College of GPs and Medical Council requirements.

Rotorua is a great central location, with many leisure and fun options on offer for time out, especially for accompanying family members. Hotel accommodation is available at group discounted pricing, with motels aplenty for those wishing to do their own thing.

The hot pools are a great way to end the day. Complimentary breakfast and evening dinner sessions are provided with a plethora of prominent speakers on widely variant topics.

Practice nurses and practice managers are essential members of general practice teams, with their own dedicated sessions on the Friday or Saturday, but able to attend the entire meeting. We are grateful for the many presenters who give of their time to assist this meeting so well. The strength of the academic programme is the key with many concurrent practical workshops throughout.

The presentations are also available to delegates for 3 months post conference on the internet for review as well.

On Saturday night there will be a memorable conference dinner with entertainment again.

Registration fees cater for trainees and practice colleagues and spouses, kept at a low level thanks to the generous support of industry, especially Boehringer Ingelheim and Medtech.

Financially general practice is more buoyant again in contrast to 5-10 years back. The stress of busy practices with ever increasing consultation rates dictates you deserve a break. We welcome you back for another great event in 2015, with over 100 workshops and quality plenary presenters. One lucky punter will win the annual travel prize, courtesy of the conference committee, for some real quality time out.

Feedback is utilised in constructing the following year's programme, and your suggestions for desired topics or speakers are acted on. Thank you for your ongoing support too. The New Zealand Medical Association supports this meeting strongly and our thanks to Lesley, Kate and their team for their assistance.

If you require any further details, visit www.gpcme.co.nz or contact the academic convenor or conference organiser.

Kind regards,



Academic Convenor

Dr Peter Chapman-Smith
e: doctor@skinandvein.co.nz
p: +64 (0)21 949 310

Conference Organiser

Conference Matters
e: leon@conferencematters.co.nz
p: +64 (0)21 164 3815
f: + 64 (0)9 437 4089

Rotorua GP CME 2015 (General Practice Conference and Medical Exhibition) event has been endorsed by The Royal New Zealand College of General Practitioners (RNZCGP) and has been approved for up to 27.75 hours CME for General Practice Educational Programme Stage 2 (GPEP2) and Maintenance of Professional Standards (MOPS) purposes.

Workshops Preliminary Day application is for 8 hours of CME

ACLS Level 7 = 12 CME credits

ACLS Level 5 = 4 CME Credits

PLATINUM SPONSOR



Speakers

- | | | |
|--|--|--|
| <p>A
John Adams
Olivia Anstis
Stuart Armstrong
Steve August
Michael Austen</p> <p>B
Kate Baddock
Tony Baird
Alan Barber
Scott Barker
Alex Bartle
Adam Bartlett
Anna Bashford
Steve Benson
Bryan Betty
Adam Bialostocki
Ross Boswell
David Bratt
Brendan Buckley
Rab Burton</p> <p>C
Lucy Cabaniuk
Jon Cadwallader
Stephen Child
Andrew Cho
Grant Cleland
Andrew Connolly
Andrew Corin
Phyllida Cotton-Barker</p> <p>D
Lance Dawber-Ashley
Farah Deobhakta
Brendan Duck
John Dunn
Alastair Dunne
Hon Peter Dunne</p> <p>E
Simon Edmonds
Colin Edwards
Kumudith Ekanayaka
Seif El-Jack</p> <p>F
Charlotte Farrant
Tony Fernando
Pat Field
Sonia Freese
George Froehle
Matt Frost</p> <p>G
Ruvyn Gabriel
Ed Gane
David Gardiner
Ivor Gerber
Brigitte Gertoberens
Mark Gittos</p> | <p>Patrick Gladding
Des Gorman
Leicester Gouwland
Trevor Gray
Marli Gregory
Andrew Grey
Kerry Gunn</p> <p>H
Murray Hames
Tony Hanne
Susan Hatters-Friedman
Anne Hawker
Lesley Hindmarsh
Lucy Holtzhausen
Dr G R C Howie</p> <p>I
Rosemary Ikram
Kate Inglis
Mark Izzard</p> <p>J
Warwick Jaffe
Ron Janes
Malcolm Johnson
Ben Johnston</p> <p>K
Sam Kain
Tracey Kain
Manish Kanolkar
Patrick Kay
Albert Ko
Jonathan Kuttner</p> <p>L
Chris Laidlaw
Anna Lawrence
Judy Leader
Hilary Liddell
Andrew Lienert
Amy Liu
Derek Luo</p> <p>M
Raina MacIntyre
Pat McCarthy
Phill McChesney
Anne-Thea McGill
Arend Merrie
Adele Miles
Chris Milne
Zac Moaveni
Jess Mowatt
Tom Mulholland
Mark Muller
Andrew Murray</p> <p>N
Rachel Noble
Mike Northmore</p> | <p>O
Claire O'Donovan
Michelle Ordner
Christine O'Sullivan</p> <p>P
Ashwin Patel
Rajan Patel
Alasdair Patrick
Karen Paxton
David Pendergrast
Shaun Phelan
Gaeline Phipps
Tania Pinfold
Philip Polkinghorne</p> <p>R
Helen Roberts
Peter Robinson
Helen Rodenburg
Christine Roke
Marilyn Rosewarne
Paul Rosser
David Rowbotham
Anna Rufer</p> <p>S
Sanjeeva
Samaraweera
Rebecca Schipper
Grant Schofield
Belinda Scott
Anurag Sekra
Nick Sharma
Marc Shaw
Branko Sijnja
VP Singh
Martin Snedden
Fiona Stewart
Franz Strydom
Boyd Swinburn</p> <p>T
Ai Ling Tan
Andrew Thompson
Janet Titchener
Andrew To</p> <p>V
Ros Vallings</p> <p>W
Ian Wallbridge
Adam Watson
Sarah Welch
Harvey White
Graeme Whittaker
Andy Whittington
Russell Wills
Hansie Wong
Grace Wong
Philip Wong</p> <p>Y
Clyde Young</p> |
|--|--|--|



Conference Content

PRE-CONFERENCE WORKSHOPS

Thursday 11 June 2015, Rotorua Energy Events Centre

To provide further practical updates, there is an optional pre-conference workshop day covering a broad range of hands-on topics, including an option to register for Basic and Advanced Surgical skills training. Please note topics are repeated content, not part 1 and 2. Some workshops have a limit on the numbers that can attend. Book early to avoid disappointment as some workshops will book out.

MAIN CONFERENCE

Friday 12 - Sunday 14 June 2015, Rotorua Energy Events Centre

Due to the popularity of the meeting, further workshop options have been added to the Saturday programme. All GPs, Practice Nurses, Practice Managers, GP Registrars and Students are welcome to attend.

PRACTICE MANAGERS PROGRAMME

Friday 12 June 2015, Rotorua Energy Events Centre

A dedicated Practice Managers programme has been developed to ensure all areas of General Practice interest are covered for this national conference. All Practice Managers are invited to attend and are welcome to attend any other sessions of interest.

PRACTICE NURSES PROGRAMME

Saturday 13 June 2015, Rotorua Energy Events Centre

A dedicated Practice Nurses programme will run concurrently with the main conference on Saturday. Practice Nurses are encouraged to register for the entire conference and are welcome to attend all sessions.

MAS WELCOME COCKTAIL FUNCTION

Friday 12 June 2015

6:30pm - 7:30pm, Exhibition Area, Energy Events Centre

Unwind after a busy first day with drinks and canapés in the Exhibition area. A chance to catch up with colleagues and meet other delegates and industry.

CONFERENCE DINNER

Saturday 13 June 2015

7:00pm - 11:00pm, Rotorua Convention Centre, \$95 per person

Join your colleagues for an evening of relaxed fun. Unforgettable entertainment is always the highlight of the dinner; this year promises another act not to be missed. Buffet dinner.

RESUSCITATION COURSES FOR GPs – LEVEL 5 & LEVEL 7

Refresher Course 4 hours / 8 credits - Initial Course 6 hours / 12 credits

Three course times on offer during the conference: Fri, Sat, & Sun; Initial Course @ \$250 and Refresher Course \$210 per person. These courses have been endorsed by the RNZCGP for 4 hours = 8 credits. These courses also meets the compulsory resuscitation skills RNZCGP MOPS and AVE requirements for GPs to obtain a certificate of competency in resuscitation skills to the New Zealand Resuscitation Council standards of Level 5. A Level 7 (8 hours) course runs on Thursday 11 June.

MAS GOLF CLASSIC

Saturday 13 June 2015, Rotorua Golf Course, Tee-off from 10:30am, \$75 per person

An always enjoyable and relaxing 18 holes at Rotorua's internationally renowned course. Includes green fees, cart hire and packed box lunch, with additional refreshments and prizes provided by MAS.

RECORDING OF SESSIONS

All main sessions will record a video image of the speaker, the audio of the speaker and the speakers actual slide presentations. All workshop sessions will capture the audio of the speaker and the speakers actual slide presentations.

Industry Exhibition

A trade exhibition will be held in the Exhibition Hall and will be an integral part of the meeting. The welcome reception, morning and afternoon refreshments and lunches will be served in the exhibition area. At the time of print the exhibition includes the following companies:

AbbVie
Actavis
AFT Pharmaceuticals
Ashburn Clinic
Aspen Pharmacare
AstraZeneca
Auckland Eye
Bay Audiology
Bayer New Zealand
Bio-Oil (BDM Grange)
bioCSL
BNZ
Boehringer Ingelheim
BPAC
Capes Medical
Capri Hospital
Care Pharmaceuticals
Coeliac New Zealand
Danone Nutricia
Douglas Pharmaceuticals
EBO5 Healthcare
Edensleep New Zealand
Esteem Healthcare
Eye Institute
Fertility Associates
Fertility New Zealand
Foot Mechanics
Galderma
GlaxoSmithKline
GO Healthy
Green Cross Health
Healthpoint
Heart Foundation
Homecare Medical
InterMed Medical
KeepItSafe
Konnect NET
Leukaemia & Blood Cancer New Zealand
Lifestyle Insurance Consultants
MAS
Medacs Healthcare
Medical Books
Medical Design Group
Medical Protection Society
Medical Specialists & Hospitals NZ
Medicus
MediRay NZ
Medtech
Medtel
MercyAscot
Ministry of Health
Ministry of Social Development
MSD
Mylan
myPractice
Neilmed
New Zealand Association of Hand Therapists
New Zealand Doctor
Novartis New Zealand
Nutricia Advanced Medical Nutrition
NZ Transport Agency
NZLocums
NZMA
NZMS
Ochre Recruitment
Pfizer
Pharmaco
Quitline
Radiant Health
Research Review
Royal New Zealand College of General Practitioners
Safe Network
Sanofi
Sleep Well Clinic
sleepdoctor.com
Smith & Nephew
Smokefree Nurses Aotearoa
Sound Business Systems
Southern Cross Health Society
Te Arai Biofarma
The Hepatitis Foundation of New Zealand
Tonig Ltd
USL Medical
Westpac
William Buck Christmas Gouland
Worldwise
Wyeth Nutrition



Please note: workshop content is repeated, not part 1 and 2 unless stated otherwise. Some workshops have a maximum number of attendees. Book early to avoid disappointment.							
0830-1030	WS #1 Basic Surgical Skills Training 1 (24 people)	WS #2 Initiation of Insulin Therapy in Family Practice	WS #3 Everyday Cardiology Problems in General Practice Illustrative Case Based Learning	WS #4 Dermoscopy Workshop Part 1	WS #5 Managing Common Eye Conditions in General Practice	WS #6 Musculoskeletal Medicine 1 Musculoskeletal Techniques : Nutrition and Nutraceuticals What Really Works?	WS #7
	Zachary Moaveni, Adam Bialostocki & Michelle Ordner Sponsor - Covidien	Manish Khanolkar, Rab Burtun	Warwick Jaffe, Albert Ko	John Adams	David Pendergrast, Sarah Welch & Paul Rosser	Ian Wallbridge, Jonathan Kuttner, Lucy Holtzhausen, Steve August	
1030-1100	Morning Tea						
1100-1300	Please note: workshop content is repeated, not part 1 and 2 unless stated otherwise.						
	WS #8 Advanced Surgical Skills Training 1 (24 people)	WS #9 Masterclass on Insulin Therapy in Family Practice	WS #10 Everyday Cardiology Problems in General Practice (Repeated) Illustrative Case Based Learning	WS #11 Dermoscopy Workshop Part 2	WS #12 Managing Common Eye Conditions in General Practice (Repeated)	WS #13 Musculoskeletal Medicine 2 What to Do for Chronic Pain and Trigger Points	ALS 7 The course covers and includes: <ul style="list-style-type: none"> • Pre-course reading 4-6 weeks in advance to help prepare for the test. • Basic Life Support • Advanced airway management (bag masking progressing to intubation) • AED and rhythm recognition • Adult and child collapse algorithms • Anaphylaxis management • A compulsory multi choice test and skills evaluation of airway management, defibrillation and some cardiac rhythms The total cost per person for the course covers, test paper, manual and certificate plus any re-sit exams required. This is a level 7 NZRC Approved (8 hrs) course, run by Jason Burns, Em-Med Training (New Zealand Resuscitation Instructor level 4-7, NZDA Approved instructor, Paediatric Advanced life support instructor). (8 hour course)
Zachary Moaveni, Adam Bialostocki & Michelle Ordner Sponsor - Covidien	Manish Khanolkar, Rab Burtun	Warwick Jaffe & Albert Ko	John Adams	David Pendergrast, Sarah Welch, Paul Rosser	Ian Wallbridge, Jonathan Kuttner, Lucy Holtzhausen, Steve August		
1300-1400	Lunch						
1400-1600	Please note: workshop content is repeated, not part 1 and 2 unless stated otherwise.						
	WS #14 Basic Surgical Skills Training 2 (24 people) - (Repeated)	WS #15 Planning for Athletic Sports with Diabetic Patients	WS #16 What Cardiac Investigation Matters in 2015?	WS #17 Dermoscopy Workshop Part 1 (Repeated)	WS #18 Clinical Pathology Case Studies	WS #19 Musculoskeletal Medicine 3 Low Back Pain - What to Do?	This is a level 7 NZRC Approved (8 hrs) course, run by Jason Burns, Em-Med Training (New Zealand Resuscitation Instructor level 4-7, NZDA Approved instructor, Paediatric Advanced life support instructor). (8 hour course)
Zachary Moaveni, Adam Bialostocki & Michelle Ordner Sponsor - Covidien	Manish Khanolkar Amy Liu Jess Mowat Heidi-Jane Humphries Stu Armstrong Discussion Panel	Patrick Kay Andrew To Ravin Gabriel Seif El-Jack Discussion	John Adams	Ross Boswell, Rosemary Ikram, Stephen Child	Ian Wallbridge, Jonathan Kuttner Lucy Holtzhausen, Steve August		
1600-1630	Afternoon Tea						
1630-1830	Please note: workshop content is repeated, not part 1 and 2 unless stated otherwise.						
	WS #20 Advanced Surgical Skills Training 2 (24 people) - (Repeated)	WS #21 Planning for Athletic Sports with Diabetic Patients (Repeated)	WS #22 What Cardiac Investigation Matters in 2015? (Repeated)	WS #23 Dermoscopy Workshop Part 2 (Repeated)	WS #24 Clinical Pathology Case Studies (Repeated)	WS #25 Musculoskeletal Medicine 4 Peripheral Joint Issues	(8 hour course)
Zachary Moaveni, Adam Bialostocki & Michelle Ordner Sponsor - Covidien	Manish Khanolkar Amy Liu Jess Mowat Heidi-Jane Humphries Stuart Armstrong Discussion Panel	Patrick Kay Andrew To Ravin Gabriel Seif El-Jack Discussion	John Adams	Ross Boswell, Rosemary Ikram, Stephen Child	Ian Wallbridge, Jonathan Kuttner Lucy Holtzhausen, Steve August		
1900-2330	Dinner own arrangements						



0700-0800	Registration
0700-0800	ACC Breakfast Session - "Focus on Fusion – The Role of Spinal Fusion in the Modern Management of Back Pain" - Dr G R C Howie Facilitator: Michael Austen
0815-0820	Welcome Address - Chairman NZMA GP Council - Kate Baddock SC: Peter Chapman-Smith
0820-0845	Peter Foley Memorial Oration "Art in Medicine" - Tony Baird
0845-0910	What is the Role of Primary Care in Childhood Obesity Prevention? - Boyd Swinburn
0910-0935	Troponins - Have They Changed Your Practice This Week? - Harvey White
0935-0955	Stroke in NZ: Results of the 4th Auckland Regional Community Stroke Study - Alan Barber
0955-1020	Why So Many Drugs after a Heart Attack - Harvey White
1020-1030	Questions and Discussion

1030-1100 Morning Tea and Exhibition

NZMA MEDICOPOLITICAL SESSION SC: Kate Baddock		or Concurrent Sessions (55mins, 11:00am-11:55am repeated at 12:05pm)							
1100-1110	Welcome Kate Baddock	WS #26 Lift The Lip	WS #27 Introduction to Medical Hypnosis	WS #28 Hypertension 101 FULL	WS #29 Stroke - Secondary Prevention	WS #30 Why Your Practice Needs an Electrocautery Unit	WS #31 myPractice User Group	WS #32 Managing ADHD in General Practice	WS #33 Use of Medicines and Boosting Adherence in NZ Primary Care Bryan Betty, Claire O'Donovan
1110-1130	Ministerial Address Hon. Peter Dunne	Rebecca Schipper	Pat McCarthy	Patrick Kay, Seif El-Jack	Alan Barber	Franz Strydom	Ashwin Patel	Tony Hanne	
1130-1230	Doing Better for Our Patients - Insights from the Profession Panel: Student, RMO - Alastair Dunne, GP - Ron Janes, Specialist - John Dunn Interlocutor and end of session reflection - Stephen Child	WS #34 Lift The Lip	WS #35 Introduction to Medical Hypnosis	WS #36 Hypertension 101 FULL	WS #37 Stroke - Secondary Prevention FULL	WS #38 Why Your Practice Needs an Electrocautery Unit	WS #39 myPractice User Group	WS #40 Managing ADHD in General Practice	WS #41 Use of Medicines and Boosting Adherence in NZ Primary Care (Repeated)
1230-1300	Q&A Discussion	(Repeated)	(Repeated)	(Repeated)	(Repeated)	(Repeated)	(Repeated)	(Repeated)	(Repeated)

1300-1400 Lunch and Exhibition

MAIN SESSION Breast Cancer Symposium - NZBCF SC: Phyllida Cotton-Barker		or Concurrent Sessions (55mins, 2:00pm-2:55pm repeated at 3:05pm)											
1400-1425	Breast Screening - What's all the fuss Marli Gregory	WS #42 Case Studies on Avoiding Diabetic Complications Manish Kanolkar, Amy Liu	WS #43 Joint Injection Techniques FULL Stuart Armstrong	WS #44 Child Protection Update - the GPs Role Russell Wills	WS #45 Investing in Global Markets Beyond 2015 Lance Dawber-Ashley	WS #46 Supporting Weight Management in Childhood Boyd Swinburn, Anne-Thea McGill	WS #47 The Role of Surgery in Modern Fertility Practice VP Singh	WS #48 Heart Attacks - What's for You and What's for Me? Harvey White	WS #49 Implementing Practice Portals Sanjeewa Samaraweera	WS #50 Update on TIAs Alan Barber	WS #51 Community Pharmacy - Friend or Foe? Brendan Duck, Anna Rufer, Janet Titchener	WS #52 Bowel Cancer Screening and Intervention Arend Merrie, Adam Bartlett, John Dunn, Philp Wong	WS #53 How to Manage Lipids in General Practice Warwick Jaffe
1425-1450	Do I Have Breast Cancer? Sonia Freese												
1450-1515	I Have Breast Cancer- What Now? Belinda Scott	WS #54	WS #55	WS #56	WS #57	WS #58	WS #59	WS #60	WS #61	WS #62	WS #63	WS #64	WS #65
1515-1540	Out of The Hospital System- What's Next? Anna Bashford	Case Studies on Avoiding Diabetic Complications	Joint Injection Techniques FULL	Child Protection Update - the GPs Role	Investing in Global Markets Beyond 2015	Supporting Weight Management in Childhood	The Role of Surgery in Modern Fertility Practice	Heart Attacks - What's for You and What's for Me?	Implementing Practice Portals	Update on TIAs	Community Pharmacy - Friend or Foe?	Bowel Cancer Screening and Intervention	How to Manage Lipids in General Practice FULL
1540-1600	Questions and Discussion	(Repeated)	(Repeated)	(Repeated)	(Repeated)	(Repeated)	(Repeated)	(Repeated)	(Repeated)	(Repeated)	(Repeated)	(Repeated)	(Repeated)

1600-1630 Afternoon Tea and Exhibition

MAIN SESSION Living With Disability: What Works Engaging with Health Professionals SC: Anne Hawker		or Concurrent Sessions (55mins, 4:30pm-5:25pm repeated at 5:35pm)											
1630-1640	Introduction Anne Hawker	WS #66 Medicus Medicolegal Forum - Key Points You Need to Know (120 minutes, not repeated)	WS #67 Key GI Concerns for GPs (120 minutes, not repeated) FULL	WS #68 Common Eyelid Problems in The Elderly Adam Watson	WS #69 Plastic Surgical Pearls Zachary Moaveni	WS #70 Hearing Loss: Detection, Diagnosis, & Management Lesley Hindmarsh, Lucy Cabaniuk	WS #71 Controversies in Breast Cancer Belinda Scott	WS #72 Taxation and Risk Planning Leicester Gouwland, Clyde Young	WS #73 Integrated Comprehensive Head & Neck Cancer Mark Izzard, Rajan Patel	WS #74 Building Blocks for Body Building Farah Deobhakta	WS #75 Jadelle Implant Training Tania Pinfold	WS #76 Rosacea: Clues for improved control Scott Barker	WS #77 PTSD, and Mental Health Through Menopause Susan Hatters-Friedman
1640-1700	Opportunities Like Everyone Else with Spina Bifida Grant Clelland												
1700-1720	Taking Charge of Change - My Adventures with Multiple Sclerosis Christine O'Sullivan			WS #78 Common Eyelid Problems in The Elderly	WS #79 Plastic Surgical Pearls	WS #80 Hearing Loss: Detection, Diagnosis, & Management	WS #81 Controversies in Breast Cancer	WS #82 Taxation and Risk Planning	WS #83 Integrated Comprehensive Head & Neck Cancer	WS #84 Building Blocks for Body Building	WS #85 Jadelle Implant Training	WS #86 Rosacea: Clues for improved control	WS #87 PTSD, and Mental Health Through Menopause
1720-1740	The Driving Force for Accessible Services for the Deaf and Others Rachel Noble	Peter Robinson, Gaeline Phipps, Jon Cadwallader, Graeme Whittaker	Alasdair Patrick, Anurag Sekra, Derek Luo, Kumudith Ekanayaka, David Rowbotham	(Repeated)	(Repeated)	(Repeated)	(Repeated)	(Repeated)	(Repeated)	(Repeated)	(Repeated)	(Repeated)	(Repeated)
1740-1810	Nice To Meet You - I'm Matt with Aspergers - Not Just A Diagnosis Matt Frost												
1810-1830	Questions and Discussion												

1830-1930	MAS Welcome Cocktail Function					MAS Welcome Cocktail Function				
	MSD SYMPOSIUM (Buffet Dinner) SC: Hon. Heather Roy - Howard Morrison Performing Arts Centre					AstraZeneca SYMPOSIUM - SC: Chris Boberg - Blue Baths				
1930-1950	Buffet Dinner					Welcome and Intro				
1950-2050	1. Immunisation Equity by 2017: 2. Arrival of a Golden Age or a Golden Duck? - Professor Raina MacIntyre, Martin Snedden					1. Practical Management Advice Post MI - Mike Williams				
2050-2100	Cake and Coffee					2. Helping Post MI Patients Remain on Treatment - Olivia Anstis				
	Cake and Coffee					Cake and Coffee				

0700-1700	Registration	
0700-0800	Abbvie Breakfast Session - 1. Casing the Joint - Practical Tips to Distinguish Different Types of Arthritis, 2. The GP's Role with Biologics for Immune-mediated Inflammatory Diseases - Tracey Kain, David Gardiner	SC: Ian St George
0700-0800	GlaxoSmithKline Breakfast Session - "One Simple Step Up For Asthma Control" - Andrew Corin	SC: Phyllida Cotton-Barker

MAIN SESSION Women's Health Symposium SC: Peter Chapman-Smith		or Concurrent Session (55mins, 8:30am-9:25am repeated at 9:35am)												ACLS 5
		WS #89	WS #90	WS #91	WS #92	WS #93	WS #94	WS #95	WS #96	WS #97	WS #98	WS #99	WS #100	
0800-0810	Period Problems Simon Edmonds	Understanding Financial Statements, and Strategic Planning Leicester Gouwland, Clyde Young	Relevant Changes re Anti Doping in Athletes Chris Milne Mark Muller	Hints to Make Life Easier for Your Patients Anne Hawker	Patient Perceptions and Uptake of Diabetes Treatment in NZ Primary Care Olivia Anstis	The Top 10 Supplements - Know What Your Patients Are Taking Hansie Wong	When Straight Becomes Bent Philip Polkinghorne	Management of Lumps in the Neck Mark Izzard, Rajan Patel	The Red Eye Sam Kain	Chronic Fatigue Syndrome - An Update Ros Vallings	Management and Investigation for Renal Colic Andrew Lienert	Managing Back Pain Stuart Armstrong	Prescribing an e-Therapy Tool for Depression Sanjeewa Samaraweera, Andy Whittington	
0810-0820	Contraceptive Tips Christine Roke													
0820-0830	Natural HRT Helen Roberts													
0830-0840	Light Bladder Leakage & Other Propaganda Anna Lawrence													
0840-0850	Pain With Intercourse Hilary Liddell													
Workshop 101-112 - above workshops repeated from 9:35am-10:30am														
0850-0900	Post Partum Depression Susan Hatters-Friedman	WS #101	WS #102	WS #103	WS #104	WS #105	WS #106	WS #107	WS #108	WS #109	WS #110	WS #111	WS #112	
0900-0910	Coronary Heart Disease in Women - Go Red for Women Fiona Stewart	Understanding Financial Statements, and Strategic Planning (Repeated)	Relevant Changes re Anti Doping in Athletes (Repeated)	Hints to Make Life Easier for Your Patients (Repeated)	Patient Perceptions and Uptake of Diabetes Treatment in NZ Primary Care (Repeated)	The Top 10 Supplements - Know What Your Patients Are Taking (Repeated)	When Straight Becomes Bent (Repeated)	Management of Lumps in the Neck (Repeated)	Difficult Hypertension in Family Practice (Repeated)	Chronic Fatigue Syndrome (Repeated)	Management and Investigation for Renal Colic (Repeated)	Managing Back Pain (Repeated)	Prescribing an e-Therapy Tool for Depression (Repeated)	
0910-0920	Update on Breast Cancer Mark Gittos													
0920-0930	Gynaecologic Malignancies Al Ling Tan													
0930-0940	Interventional Radiology for Every Woman? Brendan Buckley													
0940-0950	Assessment and Management of Fracture Risk Andrew Grey													
0950-1000	Current Risks in Pregnancy Care Charlotte Farrant													
1000-1030	Panel Discussion													

from 1000 **MAS Golf Classic** Rotorua (Arikapakapa) Golf Course; Tee off times from 10:30am

1030-1100 **Morning Tea and Exhibition**

1100-1155		WORKSHOP SESSIONS (Choose 2 options; 55min sessions repeated at 12:05pm)												ACLS 5
		WS #113	WS #114	WS #115	WS #116	WS #117	WS #118	WS #119	WS #120	WS #121	WS #122	WS #123	WS #124	
WORKSHOP SESSIONS (Choose 2 options; 55min sessions repeated at 12:05pm)		All About the Head and Neck	Widespread Pains and Nothing to be Found - Pain Clinic Approaches	Cosmetic Breast Surgery - What every Family Doctor needs to know	Links Between Periodontal and Systemic Disease	Is My Patient Fit to Fly?	CVS Guidelines: Life Time Risk and Partnership with Patients	Menorrhagia - with Mirena and Pipelle Training	Difficult Hypertension in Family Practice	Modern Vision Correction Techniques	Case Studies on Managing Anaemia	Reducing the risks in antenatal care	Ankle Sprains That are Slow to Settle - My Approach	
		Zachary Moaveni, Andrew Cho	Brigitte Gertoberens, Malcolm Johnson, Murray Harnes	Mark Gittos, Steve Benson	Rebecca Schipper	Ben Johnston	Harvey White	Simon Edmonds	Colin Edwards, Fiona Stewart	Trevor Gray	Kerry Gunn	Charlotte Farrant	Chris Milne Mark Muller	

1155-1205 **Workshop change over period**

1205-1300		WORKSHOP SESSIONS 125-136 Above workshops repeated (Choose 1 option)											
		WS #125	WS #126	WS #127	WS #128	WS #129	WS #130	WS #131	WS #132	WS #133	WS #134	WS #135	WS #136
WORKSHOP SESSIONS 124-135 Above workshops repeated (Choose 1 option)		All About the Head and Neck	Widespread Pains and Nothing to be Found - Pain Clinic Approaches	Cosmetic Breast Surgery - What every Family Doctor needs to know	Links Between Periodontal and Systemic Disease	Is My Patient Fit to Fly?	CVS Guidelines: Life Time Risk and Partnership with Patients	Menorrhagia - with Mirena and Pipelle Training	Difficult Hypertension in Family Practice	Modern Vision Correction Techniques	Case Studies on Managing Anaemia	Reducing the risks in antenatal care	Ankle Sprains That are Slow to Settle - My Approach
		(Repeated)	(Repeated)	(Repeated)	(Repeated)	(Repeated)	(Repeated)	(Repeated)	(Repeated)	(Repeated)	(Repeated)	(Repeated)	(Repeated)

1300-1400 **Lunch and Exhibition**

Initial & Refresher Courses. These courses have been endorsed by the RNZCGP for 4 hours = 8 credits and 6 hours = 12 credits.

9am-1pm - Refresher (no exam)

9am-3pm - Initial (with exam)

These courses also meets the compulsory resuscitation skills RNZCGP MOPS and AVE requirements for GPs to obtain a certificate of competency in resuscitation skills to the New Zealand Resuscitation Council standards of Level 5.

WORKSHOP SESSIONS (Choose 2 options; 55min sessions repeated at 3:05pm)														ACLS 5
1400-1455	WORKSHOP SESSIONS (Choose 2 options; 55min sessions repeated at 3:05pm)	WS #138 How to Avoid Perioperative Transfusion Kerry Gunn	WS #139 Eliminating Hep C in NZ Ed Gane	WS #140 Coronary Artery Disease - From Prevention to Cure Ivor Gerber	WS #141 Managing In-Flight Emergencies Ben Johnston	WS #142 Contraceptive and Hormonal Matters FULL Christine Roke, Helen Roberts	WS #143 Ingredients to conceive... and Why Your Patients Need to Know Andrew Murray	WS #144 Case Studies on Hip Pain Stuart Armstrong	WS #145 The Principles of Occupational Health Surveillance Des Gorman	WS #146 Anticoagulation and Safer Management of AF Fiona Stewart, Julie-Anne Bell	WS #147 Mindfulness and Compassion Training for Clinicians Tony Fernando	WS #148 Prevention and Treatment of Osteoporosis Andrew Grey	WS #149 Changing your Business Model - What do Young GPs Owners Want? Shaun Phelan	Initial Course continues until 3pm
1455-1505	Workshop change over period													
WORKSHOP SESSIONS 150-161 Above workhops repeated (Choose 1 option)														
1505-1600	WORKSHOP SESSIONS 148-159 Above workhops (Choose 1 option)	WS #150 How to Avoid Perioperative Transfusion (Repeated)	WS #151 Eliminating Hep C in NZ (Repeated)	WS #152 Coronary Artery Disease - From Prevention to Cure (Repeated)	WS #153 Managing In-Flight Emergencies (Repeated)	WS #154 Contraceptive and Hormonal Matters (Repeated)	WS #155 Ingredients to conceive... and Why Your Patients Need to Know (Repeated)	WS #156 Case Studies on Hip Pain (Repeated)	WS #157 The Principles of Occupational Health Surveillance (Repeated)	WS #158 Anticoagulation and Safer Management of AF (Repeated)	WS #159 Mindfulness and Compassion Training for Clinicians (Repeated)	WS #160 Prevention and Treatment of Osteoporosis (Repeated)	WS #161 Changing your Business Model - What do Young GPs Owners Want? (Repeated)	
1600-1630	Afternoon Tea and Exhibition													
1630-1730	WORKSHOP SESSIONS (Choose 1 option; 60min session Not repeated)	WS #162 Pain in the Pelvis Hilary Liddell	WS #163 What Can Go Wrong With Your Willy Andrew Lienert	WS #164 Low Carb High Fat Diets- How to Prescribe These Grant Schofield	WS #165 Designated Doctor Peer Review Session David Bratt	WS #166 Diagnosis and Management of Gynaecologic Cancers Ai Ling Tan, Penny Bognua	WS #167 Optimising Topical Treatment for Skin Cancer Franz Strydom	WS #168 How to Assess Sleep Disorders in a 15 minute Consultation Alex Bartle	WS #169 Genomic Medicine - Personalised Medicine for the Individual Patient Patrick Gladding	WS #170 Rural Immersion Clinical Programme Branko Sinja	WS #171 Physician Assistants/ Associates - Friend or Foe? George Froehle	WS #172 Diagnosis and Management of Insomnia for GPs Tony Fernando	WS #173 Challenges and Solutions in Contraception and Sexual Health for Young People Tania Pinfold	
1900-2300	Conference Dinner (Sponsored by Medtech) - Dine dance and entertainment - Tom Mulholland speaker													



Jet boating, Lake Rotorua



0800-0815	Registration and Coffee	
0815-0915	Successful Financial Management and Benchmarking - Shaun Phelan	SC: Mike Northmore
0915-1015	Kiwisaver and other Investment Options in the NZ Market - Lance Dawber-Ashley	
1015-1030	Questions and Discussion	
1030-1100	Morning Tea and Exhibition	
NZMA MedicoPolitical Session		
1100-1110	Open Session and presentation - Kate Baddock	
1110-1130	Ministerial Address - Hon. Jonathan Coleman	
1130-1230	Doing Better for Our Patients - Insights from the Profession Panel: Student, RMO - Alastair Dunne, GP - Ron Janes, Specialist - John Dunn Interlocutor and end of session reflection - Stephen Child	
1230-1300	Questions and Discussion	
1300-1400	Lunch and Exhibition	
1400-1425	Strategic Planning - Leicester Gouwland, Clyde Young	
1425-1445	Employment Issues - contractor versus employee, FBT, motor vehicles - Leicester Gouwland, Clyde Young	
1445-1515	Understanding Financial Statements - balance sheet, P and L, ratio analysis, year on year analysis, how to calculate the cost of a visit etc. - Leicester Gouwland, Clyde Young	
1515-1530	Questions and Discussion	
1530-1600	Afternoon Tea and Exhibition	
1600-1645	Preparing and Managing Acute Infectious Outbreaks - Marc Shaw	
1645-1800	Mobility, Privacy, Security, and ePortals - Sanjeewa Samaraweera	
1800-1830	Questions and Discussion	
1830-1930	MAS Welcome Cocktail Function	

0800-1830	Registration	
0830-0900	Breast Cancer Screening - What's All the Fuss? - Marli Gregory	SC: Marilyn Rosewarne
0900-0930	Support Services For Breast Cancer Patients - Phyllida Cotton-Barker, Pat Field	
0930-1000	Individualised Cardiac Assessment and Management - Colin Edwards	
1000-1030	Questions and Discussion	
1030-1100	Morning Tea and Exhibition	
1100-1130	Handy Hints for Making Babies - Key Messages from Nurses for Patients - Adele Miles	
1130-1200	Hormone Therapy - How to Advise Patients - Helen Roberts	
1200-1230	Increasing Awareness of Gynaecologic Cancers - Penny Bognuda, Bridgette Jackson	
1230-1300	Recent Innovations in Smoking Cessation - Grace Wong	
1300-1400	Lunch and Exhibition	
1400-1430	Incontinence - oh dear! - Anna Lawrence	
1430-1500	Why Do We Get Fat? What Should You Do About It? - Grant Schofield	
1500-1530	The Nurse's Role in Supporting Weight Management in Primary Care - Anne-Thea McGill, Kate Inglis	
1530-1600	Questions and Discussion	
1600-1630	Afternoon Tea and Exhibition	
1630-1700	Managing Chronic Pain Patients - Judy Leader	
1700-1730	Gastro-Oesophageal Reflux Disease - Alasdair Patrick	
1730-1800	Update on Cataracts and Vision Correction - Trevor Gray	
1800-1815	Questions and Discussion	
1900-2300	Conference Dinner (Sponsored by Medtech) - Dine and Dance - Tom Mulholland speaker	

0700-1700	Registration											
0715-0815	GlaxoSmithKline Breakfast Session - Is A Little Prick Enough? Vaccines for Travelling - Marc Shaw - Breakfast served from 7am											SC: Tim Wilkinson
MAIN SESSION SC: Graeme Whittaker		or Concurrent Session (55mins, 8:30am-9:25am repeated at 9:35am)										
	WS #175	WS #176	WS #177	WS #178	WS #179	WS #180	WS #181	WS #182	WS #183	WS #184	WS #185	WS #186
0830-0855	Medtech User Group	What You Need to Know About The Safe Use of Local Anaesthesia	Practical Rapid Hypnosis for Relaxation	Skin Cancer Surgery Pearls	Models of Care for Long term Conditions	Hep B Screening and Surveillance in Primary Care	Recurrent Miscarriage - Current Diagnosis and Management	Pelvic Pain	Hazards & Servicing Program for Medical Devices	Shoulders Made Simple	The Importance of Taking an Accurate Sleep History	ECG Case Studies
0855-0920	Antithrombotic Therapy in Atrial Fibrillation Colin Edwards									FULL Chris Milne		
0920-0945	Good News for The Macular Generation Andrew Thompson	Sanjeewa Samaraweera	Kerry Gunn	Pat McCarthy	Mark Gittos, Steve Benson	Helen Rodenburg	Ed Gane	Phill McChesney	Simon Edmonds		Nick Sharma	Alex Bartle
0945-1010	Things That Make You Go Blind Philip Polkinghorne	Workshop 187-198 - above workshops repeated from 9:30am-10:25am										
	WS #187	WS #188	WS #189	WS #190	WS #191	WS #192	WS #193	WS #194	WS #195	WS #196	WS #197	WS #198
1010-1030	Medtech User Group	What You Need to Know About The Safe Use of Local Anaesthesia	Practical Rapid Hypnosis for Relaxation	Skin Cancer Surgery Pearls	Models of Care for Long term Conditions	Hep B Screening and Surveillance in Primary Care	Recurrent Miscarriage - Current Diagnosis and Management	Pelvic Pain	Hazards & Servicing Program for Medical Devices	Shoulders Made Simple	The Importance of Taking an Accurate Sleep History	ECG Case Studies
	(Repeated)	(Repeated)	(Repeated)	(Repeated)	(Repeated)	(Repeated)	(Repeated)	(Repeated)	(Repeated)	FULL (Repeated)	(Repeated)	(Repeated)
1030	Industry Prize Announcements											
1030-1100	Morning Tea and Exhibition											
1100-1125	Does Compassion Still Matter? - Tony Fernando											SC: Peter Chapman-Smith
1125-1150	Making Ends Meet - Chris Laidlaw											
1150-1215	Challenges Facing Regulators and Healthcare Delivery - Andrew Connolly											
1215-1245	The Health Leadership Challenge and Discussion - Des Gorman											
1245-1300	Questions and Discussion											
1300	Conference Closes											



Trout Fishing, Lake Rotorua



Accommodation

Block bookings at negotiated rates have been made at three hotels in Rotorua. Please book your accommodation on the enclosed registration form.

Registration and accommodation should be made at your earliest opportunity as hotel rooms are not guaranteed until confirmed. Millennium Hotel will book out at least 6 weeks prior to the conference.

	Rating	Price (from)
Millennium Hotel Rotorua - (5min walk)	★★★★☆	\$165
Novotel Rotorua - (15min walk)	★★★★	\$150
Sudima Hotel Rotorua - (5min walk)	★★★★	\$140

MILLENNIUM HOTEL ROTORUA

Eruera Street, Rotorua (Cnr Hinemaru Street)

Located on the shores of Lake Rotorua and just a brief walk from the central business district, the Millennium Hotel Rotorua is conveniently sited for conference visitors and an ideal base for partners/families exploring the wide variety of leisure pursuits in the Rotorua region.

- Premium Room \$165
- Premium Lake View Room \$185
- Deluxe Club Room - 5th Floor \$215

NOVOTEL ROTORUA

Lake end Tutanekai Street

Novotel Rotorua Lakeside is a leading 4 star hotel located on the shores of Lake Rotorua. The resort features an indoor spa and fitness centre, offering geothermally heated pools, a Cafe, restaurant and bar, and complimentary car parking. Guests can make the most of nearby attractions, including water activities on the lake and the famous thermal reserves.

- Superior Room (1-2 people) \$150
- Lake View Room (1-2 people) \$180

SUDIMA HOTEL ROTORUA

1000 Eruera Street

“Location, location, location” best describes Rotorua’s largest hotel. Set on the shores of beautiful Lake Rotorua, adjacent to the famous Polynesian Spa complex, Government Gardens, and only a five minute stroll to the city centre is Sudima Hotel Lake Rotorua.

- Standard Room (1-2 people) \$140

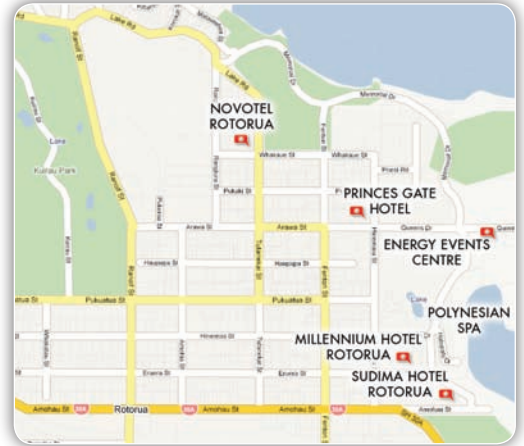

Bungee Jumping Rotorua



Skyline Gondola over Rotorua



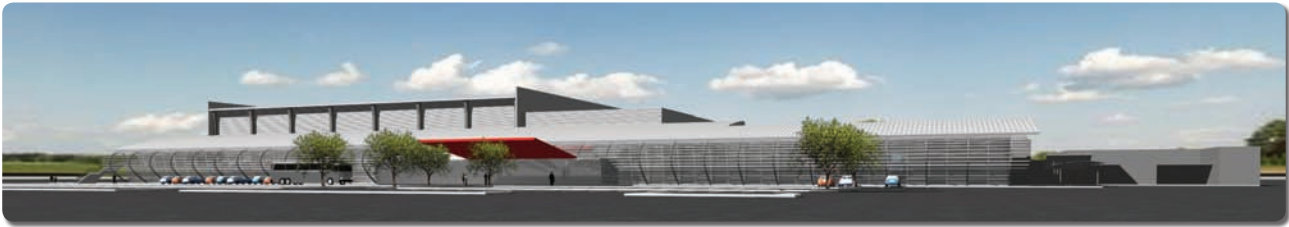

Rotorua's Energy Events Centre is located in Government Gardens, immediately behind the iconic Bath House building housing the city's Museum of Art and History. The Energy Events Centre is a purpose-built events complex incorporating the Southern Trust Sportsdrome, BayTrust Forum, Unison Arena, Grand Hall, and a number of breakout rooms. It is just a few minutes walk from its sister facility, the Rotorua Convention Centre, and from major hotels, cafes and restaurants.

Map of Rotorua

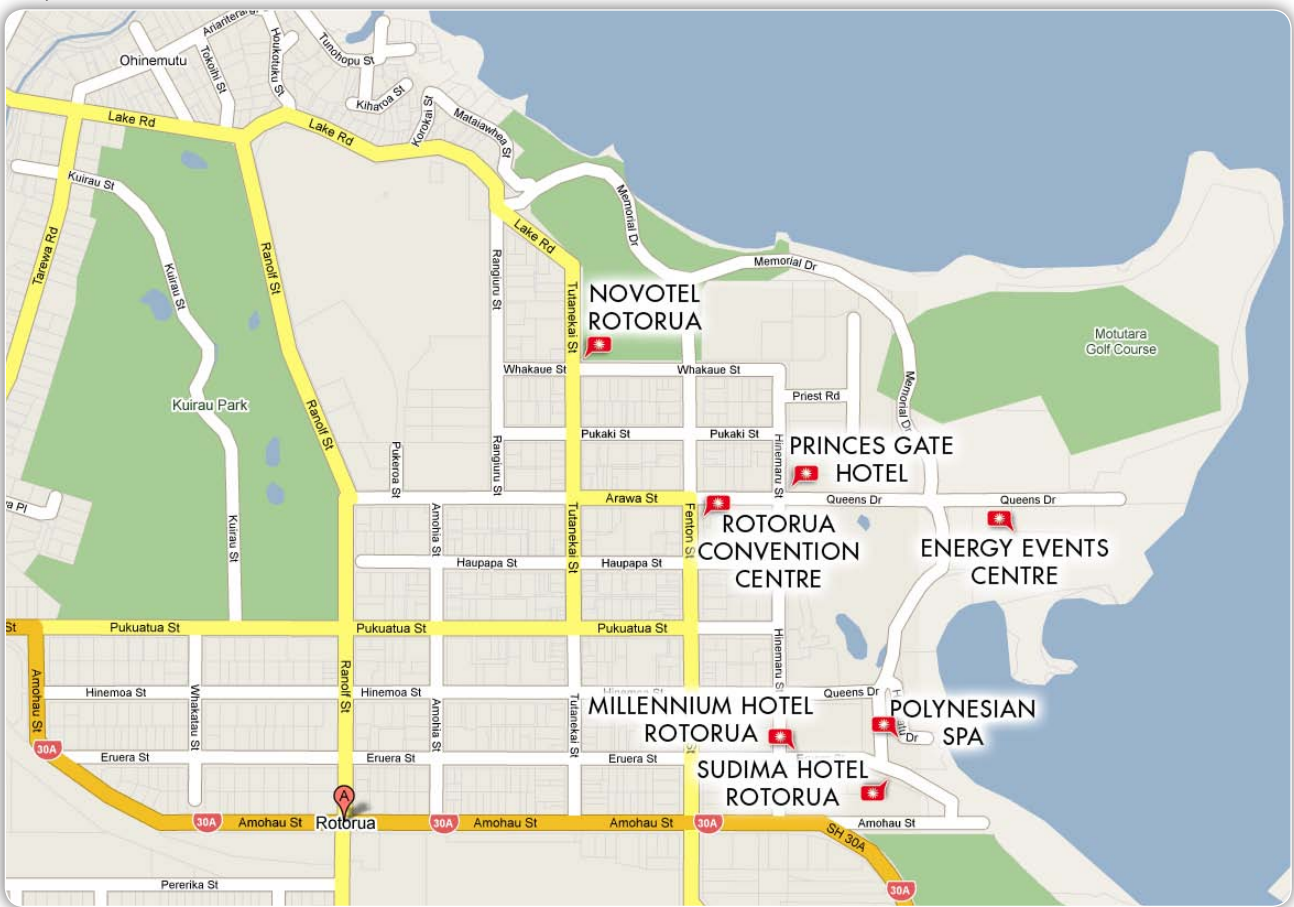

Useful Contact Numbers

Conference Matters	021 164 3815	Ambrosia Restaurant & Bar	07-348 3985
Millennium Hotel	07 347 1234	Lake End 1096 Tutanekei Street	
Sudima Hotel	07 348 1174	The Pig and Whistle Historic Pub	07 347 3025
Princes Gate Hotel	07 348 1179	Cnr Haupapa and Tutanekei Streets	
Novotel Rotorua.....	07 346 3888	Seismic Gastrobar	07 348 2082
Alpha Displays	027 495 1053	1158 Whakaue Street	
Energy Events Centre	07 349 5631	Bistro 1284	07 346 1284
Super Shuttle	07 345 7790	1284 Eruera St - Judged Rotorua's best restaurant	
Taxi	07 348 1111	Lonestar.....	07 349 4040
Polynesian Spa	07 348 1328	Cnr Arawa & Amohia St	
Spa Treatments	07 343 1665	Amazing Thai Restaurant	07 343 9494
Life Pharmacy	07 348 8749	1246 Fenton Street	
		Lovely India.....	07 348 4088
		1123 Tutanekei Street	



Rotorua Energy Events Centre Layout

Queens Drive, Government Gardens

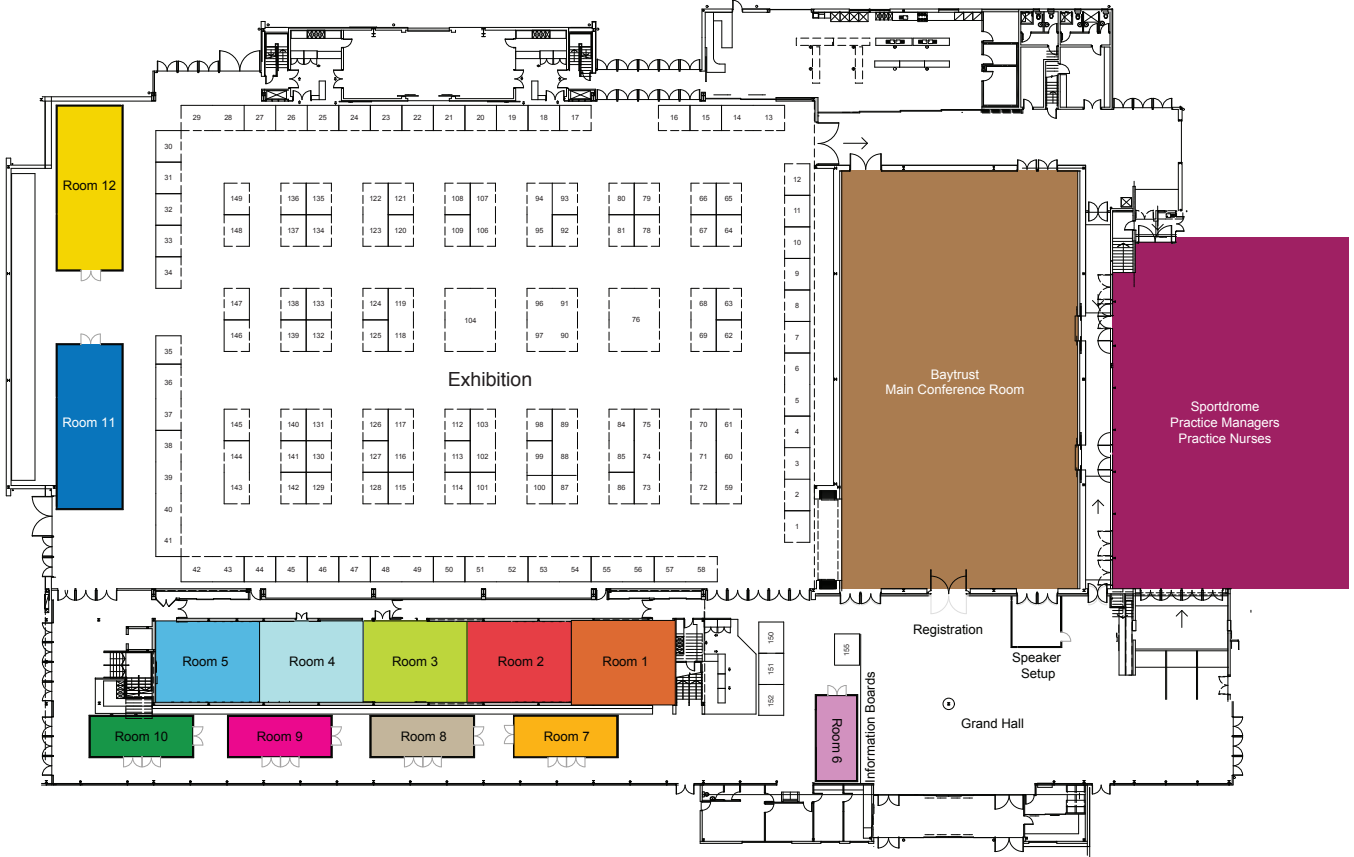

Blue Baths, Rotorua



Your professional association

Welcome to the NZMA GPCME 2015!

The New Zealand Medical Association is proud to represent and advocate for its GP members and their vital role in the primary care of all New Zealanders.



Advocacy

The NZMA is a strong advocate for issues affecting GPs and General Practice, including training programmes, funding, integration between primary and secondary care, after-hours service provision, and the development and implementation of health policy.

Representation

The NZMA General Practitioner Council (GPC) represents the interests of our GP members across a wide range of issues and comprises elected members. The NZMA is a member of the General Practice Leaders' Forum along with fellow GP organisations.

Support

The NZMA represents 600 general practices in the PHC MECA negotiations. NZMA members have free access to the NZMA advisory service, which provides advice on a variety of issues from employment, staff issues and running a practice to health and safety and doctor's wellbeing.

Your support allows us to do more to benefit you. Come and see us at Stand 1 for information on how you can benefit yourself and your profession by becoming a member.

Join us today.

www.nzma.org.nz
0800 65 61 61
nzma@nzma.org.nz



Download Your Mobile App Now!

<https://crowd.cc/gpcme2015>



You can also scan this code with a QR Reader on your device.

ROTORUA GP CME 2015 REGISTRATION FORM

Rotorua Energy Events Centre | 11-14 June 2015 | www.gpcme.co.nz

PERSONAL DETAILS

Title: Miss / Mrs / Ms / Mr / RN / Dr / Prof / Assoc Prof

First Name: _____ Surname: _____

Phone Bus: _____

Company / Clinic Name: _____

Fax: _____

Clinic location: _____
City/Town

Mobile: _____

Preferred Contact Address: _____
Street

Special requests: (ie dietary requests, disabilities, etc)

_____ Suburb _____ Country

_____ City/Town _____ Post Code

Required for registration confirmation

Email: _____

Yes, I would like to receive email updates regarding products and special offers from attending industry exhibitors

Additional Attendees: _____
Title, First Name, Last Name

CANCELLATION POLICY: Cancellations can only be received in writing, and incur a loss of 50% of registration fees within 21 days of the conference commencing. Later cancellations forfeit registration fees paid. Any other refunds are at the discretion of the organisers.

PRIVACY: The contact information supplied on the registration form will be distributed to the attending industry sponsors. Please tick this box if you do not wish to be included on this list.

REGISTRATION FEES (GST Inclusive - NZD)

Delegate NZMA Members (Fri-Sun) \$745 \$ _____

Delegate Non-Member (Fri-Sun) \$895 \$ _____

Less early bird discount if booked before Friday 08 May Deduct \$100.00

GPEP1 Registrar (Fri-Sun) \$295 \$ _____

GPEP2 Registrar (Fri-Sun) \$425 \$ _____

Student (Fri-Sun) \$135 \$ _____

Exhibition Attendees \$345 \$ _____

Practice Manager All or Fri only \$185 \$ _____

Practice Nurse All or Sat only \$135 \$ _____

Spouse (non medical).....\$135 \$ _____

Or Daily Registration

Friday \$400 Saturday \$400 Sunday \$250 \$ _____

Late Registration Fee if booked after Friday 22 May \$ 50.00

Optional Registration

Friday - ACC Breakfast Session No. \$ No Fee

Friday - MAS Welcome Cocktails No. \$ No Fee

Friday - MSD Symposium No. \$ No Fee

Friday - AstraZeneca Symposium No. \$ No Fee

Saturday - AbbVie Breakfast Session No. \$ No Fee

Saturday - GSK Breakfast Session No. \$ No Fee

Saturday - MAS Golf Classic No. @ \$75 \$ _____

Saturday - Conference Dinner (Medtech) No. @ \$95 \$ _____

Sunday - GSK Breakfast Session No. \$ No Fee

TOTAL REGISTRATION FEE (TOTAL A) \$

PRE-CONFERENCE WORKSHOPS - Thursday

NZMA Member Thursday \$375 \$ _____

Non Member Thursday \$475 \$ _____

Nurse Thursday \$135 \$ _____

Basic & Advanced Surgical Skills Course \$695 \$ _____

Level 7 NZRC Course (Includes Manual) \$510 \$ _____

TOTAL PRE-CONFERENCE WORKSHOP FEE (TOTAL B) \$

Please indicate your preferred workshop option **number** for each time slot.

_____ 8:30am _____ 11:00am _____ 2:00pm _____ 4:30pm

EMERGENCY RESUSCITATION FOR GPs (Level 5)

I wish to attend the Initial Course @ \$250 or Refresher Course @ \$210 per person

Initial or Refresher - Fri Sat Sun

EMERGENCY RESUSCITATION FEE (TOTAL C) \$

CONCURRENT WORKSHOP OPTIONS

Please indicate your preferred workshop option **number** for each time slot. Please note numbers are restricted with spaces allocated when registration received. Tickets required for entry.

Fri _____ 11am _____ 12pm _____ 2pm _____ 3pm _____ 4:30pm _____ 5:30pm

Sat _____ 8:30am _____ 9:30am _____ 11am _____ 12pm _____ 2pm _____ 3pm _____ 4:30pm

Sun _____ 8:30am _____ 9:30am _____ Office use only

ACCOMMODATION AVAILABLE

Arrival Date _____ June Departure Date _____ June

Special Requirements/ Comments _____

Millennium Hotel Rotorua (5 mins walk)

Premium Room _____ nights x _____ \$165 \$ **FULL**

Premium Lake View Room _____ nights x _____ \$185 \$ **FULL**

Deluxe Club Room _____ nights x _____ \$215 \$ **FULL**

Sudima Hotel Rotorua (5 mins walk)

Standard Room (1-2 people) _____ nights x _____ \$140 \$ _____

Novotel Hotel Rotorua (15 mins walk)

Superior Room (1-2 people) _____ nights x _____ \$150 \$ **FULL**

Lake View Room (1-2 people) _____ nights x _____ \$180 \$ **FULL**

TOTAL ACCOMMODATION FEE (TOTAL D) \$

A+B+C+D = TOTAL ENCLOSED (GST Inc) \$

PAYMENT DETAILS GST Tax Invoice Number 95-598-579

I authorise Conference Matters to charge my Visa / Mastercard as detailed below, with the amount of \$ _____

Card Number: _____

_____ / _____ / _____ Date _____ / _____ / _____

Card expiry date _____ / _____ Date _____ / _____ / _____

Print Cardholder's Name _____

Cardholder's Signature _____

Cheque: \$ _____ (NZD) payable to: Conference Matters.

Direct Credit 03-0498-0809412-00 Ref: Surname ROTGPCME

Return this form to Conference Matters, Fax +64 (0)9 437 4089 or post to PO Box 1661, Whangarei, New Zealand
All Enquiries to Leon +64 (0)21 164 3815 or leon@conferencematters.co.nz

FreePost Authority Number 215519



Conference Matters Ltd
PO Box 1661
Whangarei 0140